



THE GEORGE

G
The George
PUBS & RESTAURANTS

TO LET
01473 552 556

G
The Libby's
The George
PUBS & RESTAURANTS

G
The George
PUBS & RESTAURANTS

The George Shopping Centre, Grantham

£199,950 Leasehold

Retail for sale

Description

Location

The George Centre is situated within Grantham town centre being accessible from High Street, Guildhall Street and Westgate. Grantham is an established market town in South Lincolnshire being approximately 23 miles east of Nottingham and 25 miles south of Lincoln, having a residential population of approximately 40,000 people with a large catchment area.

Description

The premises comprise of a ground floor double retail unit with a double fronted timber framed shop front offering superb signage opportunities. The premises has entrance from the High Street as well as the George Shopping Centre. It may lend itself to alternative uses and we would advise any incoming tenant to make their own enquires to this regard. The premises was previously used by a known retailer and is in good condition. The flooring are fully carpeted, with ample storage space with separate storage units and W.C.



Accommodation

The premises have been measured in accordance with the RICS code of measuring practice on a net internal floor area basis.

Total NIA - 251.1 Sq m (2,703 Sq ft)

Services

We understand that mains electricity, water and drainage are connected. None of the heating systems or any other plant and equipment has been tested by Crystal & Co and prospective clients must rely on their own investigations as to their existence and condition.

Terms

999 Years lease

Price

Competitive asking price of £199,950 per annum excluding VAT for the long leasehold interest in the property.

Service Charge

To be advised.

Rateable Value

To be advised

VAT

Vat is applicable

Uses

All uses considered, currently E License. We would advise any incoming tenant to make their own enquires to this regard.

Tenure: Leasehold (999 years)

Service Charge:

Tenure

Leasehold

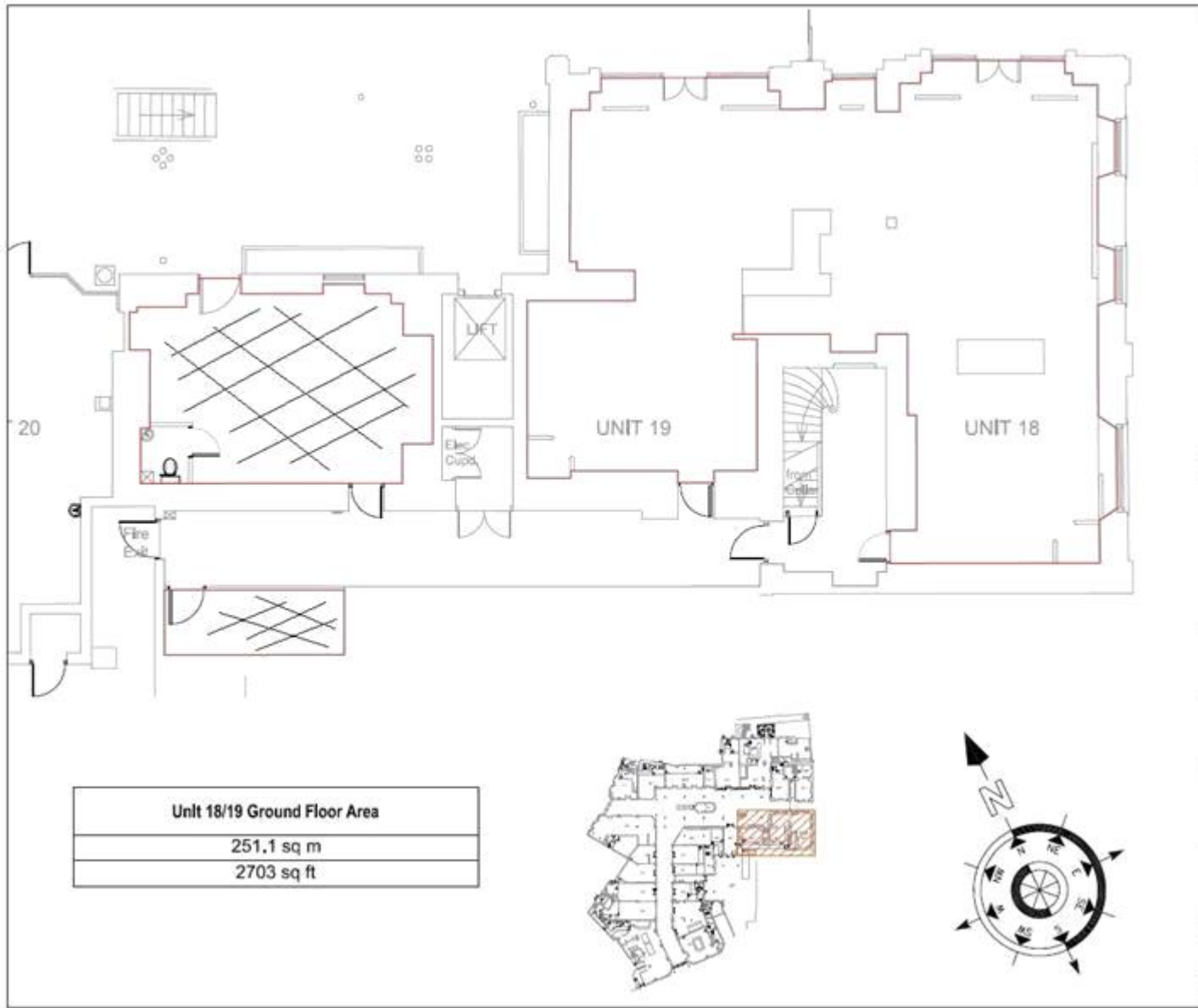



Viewing by appointment only
 Crystal & Co - Head Office
 21 Progress Business Centre, Whittle Parkway, Slough, Berkshire SL1 6DQ
 Tel: 0208 568 7766 Email: info@crystalestates.co.uk Website: <https://www.crystalestates.co.uk>

